

UNDERCOUNTER REFRIGERATOR

Model #PWTR27, PWTR48, PWTR60, PWTR72

Features

- 430 type stainless steel exterior
- Aluminum interior with 304 type stainless steel floor
- Compact, undercounter size takes up minimal space
- Easy-to-read digital temperature controller and auto-defrost function
- Self-closing and stay-open door features for easy loading and unloading
- Uses R-290 refrigerant; 115V, 1/3 hp

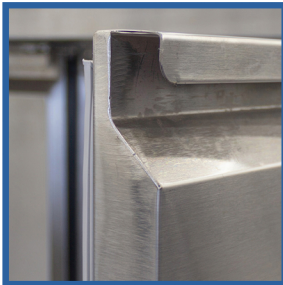

(401)-639-3271

www.northamericanrefrigeration.com

© 2016 North American Restaurant Equipment





Product Specifications

Model #PWTR27, PWTR48, PWTR60, PWTR72

27 TOP VIEW

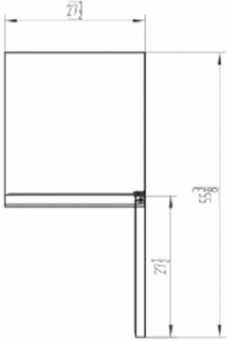

48 TOP VIEW

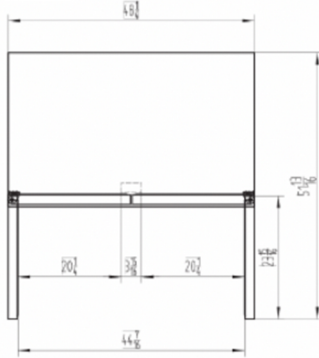

60 TOP VIEW

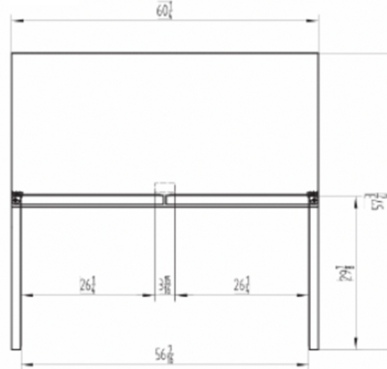

72 TOPVIEW

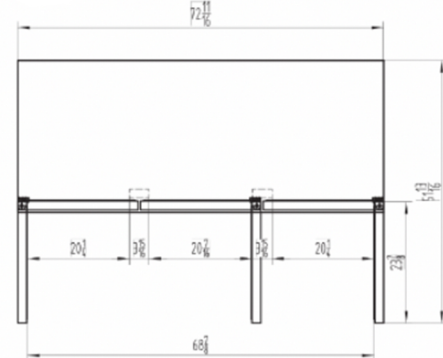

27 FRONT VIEW

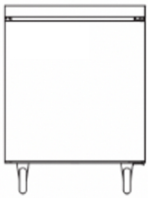

48 FRONT VIEW

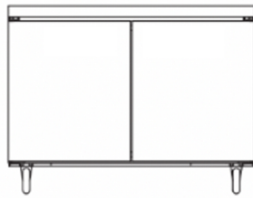

60 FRONT VIEW

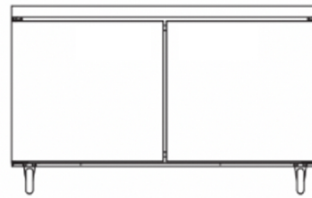

72 FRONT VIEW

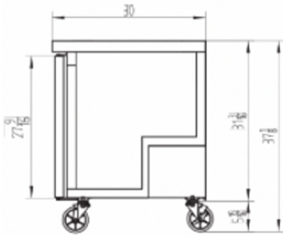
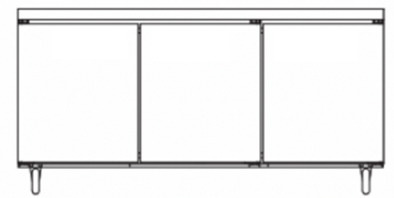

ALL MODELS SIDE VIEW

For best results of food preservation, we recommend setting your refrigerator between 33° F - 38° F

1. Don't forget to leave the unit some room to breathe!
2. Please clean the condenser frequently to give the unit more fresh air.

UNDERCOUNTER REFRIGERATOR SERIES - PRODUCT SPECIFICATIONS

Model	Doors	Cubic Feet	Shelves	Exterior Dimensions W x D x H	Packing Dimensions W x D x H	Castors	Gross Weight	HP	Voltage	Amps	Refrigerant
PWTR-27	1	6.5	1	27.48" x 30" x 37.16"	30.3" x 33.6" x 38.2"	5"	170 lbs.	1/6	115/60/1	3.2	R-134a
PWTR-48	2	12	2	48.23" x 30" x 37.16"	51.2" x 33.6" x 38.2"	5"	231 lbs.	1/6	115/60/1	4.2	R-134a
PWTR-60	2	17.9	2	60.24" x 30" x 37.16"	63" x 33.6" x 38.2"	5"	275 lbs.	1/4	115/60/1	4.2	R-134a
PWTR-72	3	32.8	3	72.68" x 30" x 37.16"	75.5" x 33.6" x 38.2"	5"	315 lbs.	1/4	115/60/1	4.2	R-134a

(401)-639-3271

www.northamericanrefrigeration.com

© 2016 North American Restaurant Equipment

