

# UNDERCOUNTER FREEZER

Models PWTF27, PWTF48, PWTF60, PWTF72

## Features

- 430 type stainless steel exterior
- Aluminum interior with 304 type stainless steel floor
- Compact, undercounter size takes up minimal space
- Easy-to-read digital temperature controller and auto-defrost function
- Self-closing and stay-open door features for easy loading unloading loading and and unloading
- Uses R-290 refrigerant; 115V, 1/3 hp

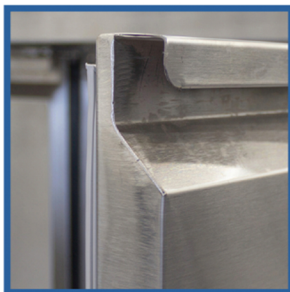

(401)-639-3271

[www.northamericanrefrigeration.com](http://www.northamericanrefrigeration.com)

© 2016 North American Restaurant Equipment





# Product Specifications

Models PWTF27, PWTF48, PWTF60, PWTF72

## UNDERCOUNTER FREEZER

27 TOP VIEW

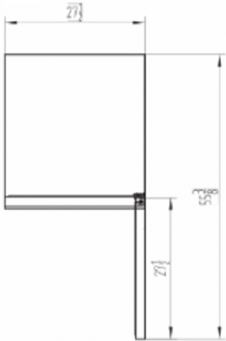

48 TOP VIEW

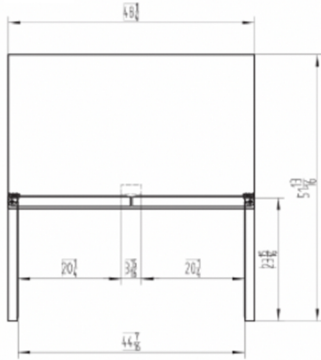

60 TOP VIEW

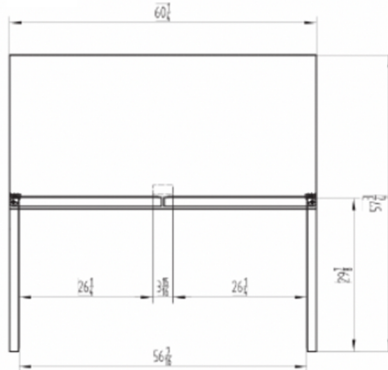

72 TOPVIEW

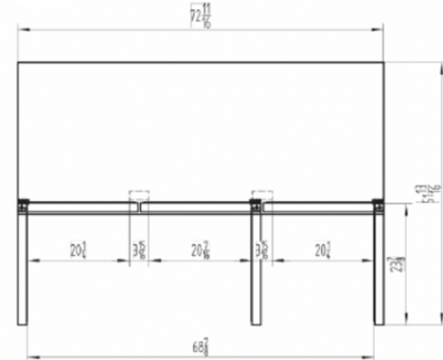

27 FRONT VIEW

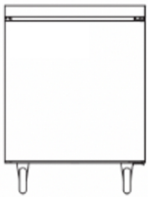

48 FRONT VIEW

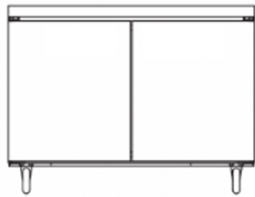

60 FRONT VIEW

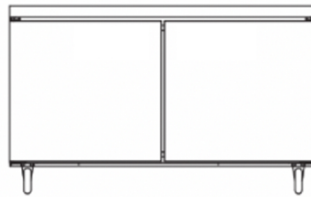

72 FRONT VIEW

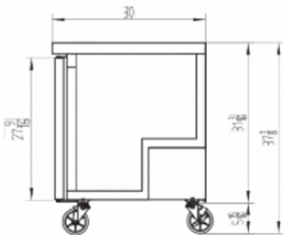
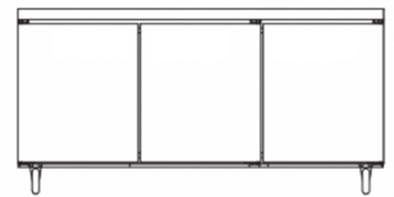

ALL MODELS SIDE VIEW

1. Don't forget to leave the unit some room to breathe!
2. Please clean the condenser frequently to give the unit more fresh air.

### UNDERCOUNTER REFRIGERATOR SERIES - PRODUCT SPECIFICATIONS

Model	Doors	Cubic Feet	Shelves	Exterior Dimensions W x D x H	Packing Dimensions W x D x H	Castors	Gross Weight	HP	Voltage	Amps	Refrigerant
PWTF-27	1	6.5	1	27.48" x 30" x 37.16"	30.3" x 33.6" x 38.2"	5"	170 lbs.	1/6	115/60/1	3.2	R-134a
PWTF-48	2	12	2	48.23" x 30" x 37.16"	51.2" x 33.6" x 38.2"	5"	231 lbs.	1/6	115/60/1	4.2	R-134a
PWTF-60	2	17.9	2	60.24" x 30" x 37.16"	63" x 33.6" x 38.2"	5"	275 lbs.	1/4	115/60/1	4.2	R-134a
PWTF-72	3	32.8	3	72.68" x 30" x 37.16"	75.5" x 33.6" x 38.2"	5"	315 lbs.	1/4	115/60/1	4.2	R-134a

(401)-639-3271

[www.northamericanrefrigeration.com](http://www.northamericanrefrigeration.com)

© 2016 North American Restaurant Equipment

